

## MANUAL

Please read these instructions carefully before starting the installation. We assume no liability for any damage caused by not following the instructions below.

1. Start the installation after making sure that the engine and the bulbs are cold enough to avoid burns.
2. During the installation the light switch must be off.
3. Do not drop, scratch or stain xenon bulbs during the installation.
4. Check the voltage source, all connections and cables for their efficiency in order to avoid problems with the inclusion and use of the lights.
5. Make sure that ballasts do not change the polarity of connection "+" and "-"
6. Install ballasts away from the heat source, which is the engine, to not damage them.

## THE INSTALLATION PROCESS

1. If necessary, remove the headlights of the car.

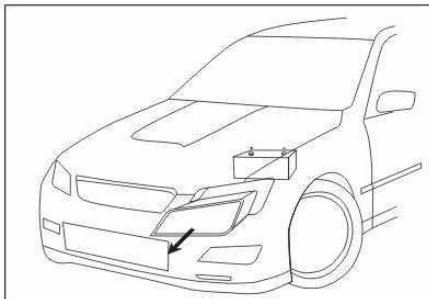

2. Remove the old halogen lamp located in the back of the reflector (after removing the plastic cover).

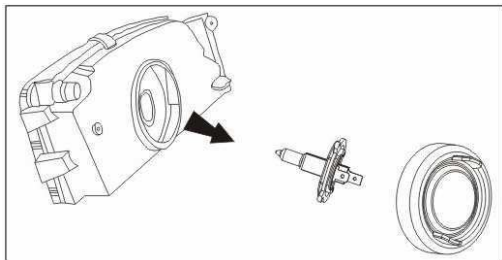

3. Drill a hole of diameter 25mm in the plastic cover.

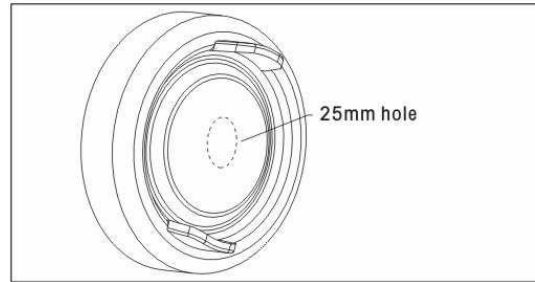

4. Remove the plastic cover from the bulb and install it in place of the removed halogen bulb using the same element (wire) as when installing halogen bulb. Note: Make sure that glass part of the xenon bulb is not dirty. If so, clean it with a dry cloth and alcohol.

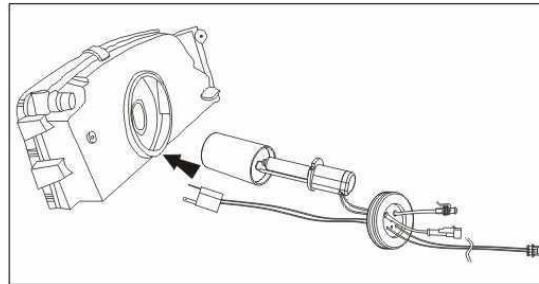

5. Reinstall the plastic cover after putting wires in drilled hole and seal connection with rubber ring installed on the cables.

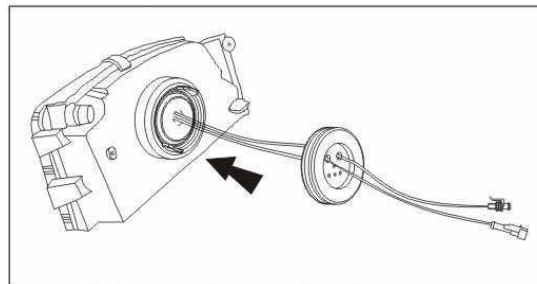

6. Install the connection following the picture below. Install ballasts in the nearest possible place next to the reflector using cable ties or attached coasters. Remember to locate high-voltage cables away from other electrical wirings. Otherwise, there may appear interference in electronic systems of the vehicle.

**Note:** Remember to put the ballasts away from direct heat source, which is the engine, and the places directly exposed to water.

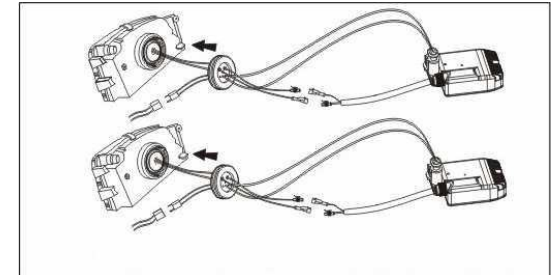

7. After installation of all cables and ballasts, check correct operation of the new light source in your car - xenon headlights.  
**Note:** If both lights do not turn on at the same time, replace the battery with a more powerful one with a capacity of 60Ah because the problem may be too small tension of ballasts. Replace fuses of headlights to have a value of at least 20A.

**ATTENTION !!!**  
**DO NOT TURN ON LIGHTS BEFORE CONNECTING TO BALLASTS!**